

Lithium Iron Phosphate Battery

LFELI-48200T-SNMP (48V200Ah)



Features Of LiFePO4 Battery

- 20-year design life
- Extreme cycle life - up to 3500 cycles at 100% DOD
- Extreme temperature range: -4°F~140°F (-20°C~60°C)
- Advanced Battery Management System (BMS) - System monitoring of voltage, current and temperature
- Built-in overcharge, overdischarge and overheat protection
- Advanced BMS communication protocols - Modbus, RS232, RS485 and SNMP
- Anti-theft tracking systems available Gyroscope
- Flexibility in configuration - Supports parallel connection of up to 40 modules
- Flame retardant system to UL94V-0 & >28% LOI
- Easy installation - 19"/23" standard cabinet or wall mounting



Physical Dimension-mm

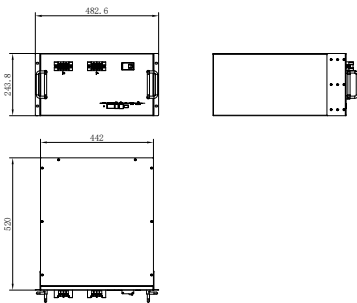

Typical Applications

- Access Network Equipment
- Remote Switching Offices
- Mobile Communication Equipment
- Transmission Equipment
- Satellite Ground Stations
- Microwave Communication Equipment
- Communication field as backup power supply

| Item | Parameters |
|------------------------------------|--|
| Model | LFELI-48200T-SNMP |
| Rated Capacity (5HR) | 200 Ah |
| Nominal Voltage | 48V |
| Discharge Ending Voltage | 40.5V |
| Charging Limited Voltage | 54V |
| Max. Charging/Discharge Current | 100A |
| Weight | Approx. 79.2KG |
| Energy | 9600Wh |
| Display | Without LCD display |
| Max. number of parallel connection | 40 |
| Dimensions (W*D*H) mm | 442*520*244 |
| Design Life | 20 years |
| Cycle Life | 6000 cycles |
| IP Class | IP30 |
| Case Material | SPCC |
| Operating Temperature | Charging: 0 to +45°C, Discharging: -10 to +55°C, Storage: -20 to +60°C |

Constant Current Discharge Table (Amperes) at 25°C

| Voltage \ Time | 2 h | 4 h | 6 h | 10 h | 20 h |
|--------------------------------|------|-----|-------|------|------|
| End of discharge voltage 40.5V | 100A | 50A | 33.3A | 20A | 10A |

Constant Power Discharge Table (Watts) at 25°C

| Voltage \ Time | 2 h | 4 h | 6 h | 10 h | 20 h |
|--------------------------------|-------|-------|-------|------|------|
| End of discharge voltage 40.5V | 4800W | 2400W | 1600W | 960W | 480W |